

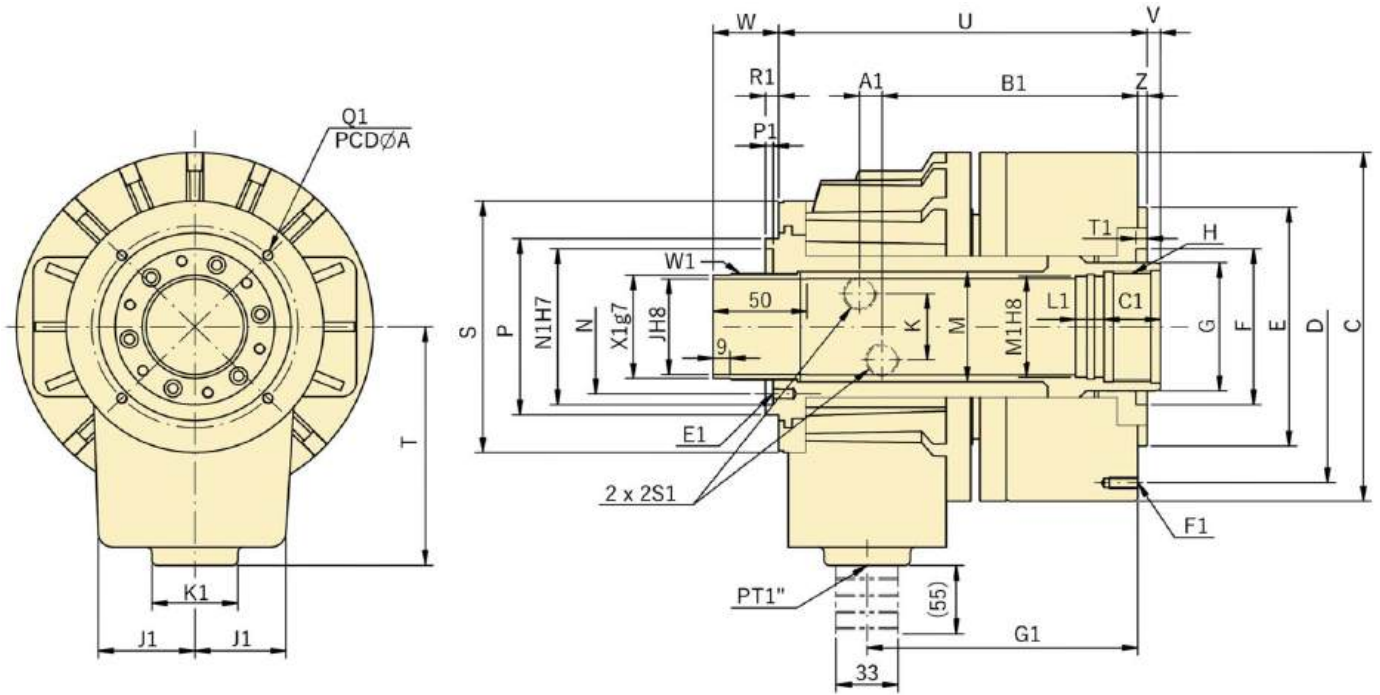

# RC- SERIES

高速中空迴轉油壓缸

HIGH SPEED THROUGH HOLE ROTARY HYDRAULIC CYLINDER



## SPECIFICATION

MODEL	活塞面積 Effective Piston Area (cm <sup>2</sup> )		活塞行程 Piston Stroke (mm)	最高使用迴轉速 Max. Speed (r.p.m)	最高使用壓力 Max. Pressure (kgf / cm <sup>2</sup> )	慣性矩 Moment of Inertia (kgf·m <sup>2</sup> )	重量 Weight (kg)	回油量 (含內部排油量) Max. oil leakage from drain port and max. internal oil leakage (lit / min)
	押側 Extend	引側 Retract						
RC-4	47	41.5	9	8000	40	0.01	5.6	3
RC-5	67	64.5	15	8000	40	0.013	8.6	3
RC-6S	100	89	15	8000	40	0.029	12.3	3
RC-6	100	89	15	7000	40	0.029	12	3
RC-8S	161	150	22	6200	40	0.045	17	3.9
RC-8	161	150	22	6200	40	0.045	16.8	3.9
RC-10S	198	183	25	4700	40	0.09	27	4.2
RC-10	198	183	25	4700	40	0.029	26.5	4.2
RC-10X	198	183	25	4700	40	0.029	26	4.2
RC-12	252	234	30	3800	40	0.16	33	4.5
RC-15	345	336	23	2800	40	2.34	55	7

## 超大孔徑迴轉油壓缸 SUPER LARGE THROUGH-HOLE ROTARY HYDRAULIC CYLINDER

### SPECIFICATION

MODEL	活塞面積 Effective Piston Area (cm <sup>2</sup> )		活塞行程 Piston Stroke (mm)	最高使用迴轉速 Max. Speed (r.p.m)	最高使用壓力 Max. Pressure (kgf / cm <sup>2</sup> )	慣性矩 Moment of Inertia (kgf·m <sup>2</sup> )	重量 Weight (kg)	回油量 (含內部排油量) Max. oil leakage from drain port and max. internal oil leakage (lit / min)
	押側 Extend	引側 Retract						
RC-2814	397.2	354.3	42	2000	33	1.079	98.9	9.5
RC-2816	397.2	354.3	42	2000	33	0.842	84.3	9.5



# RC- SERIES

高速中空迴轉油壓缸

HIGH SPEED THROUGH HOLE ROTARY HYDRAULIC CYLINDER

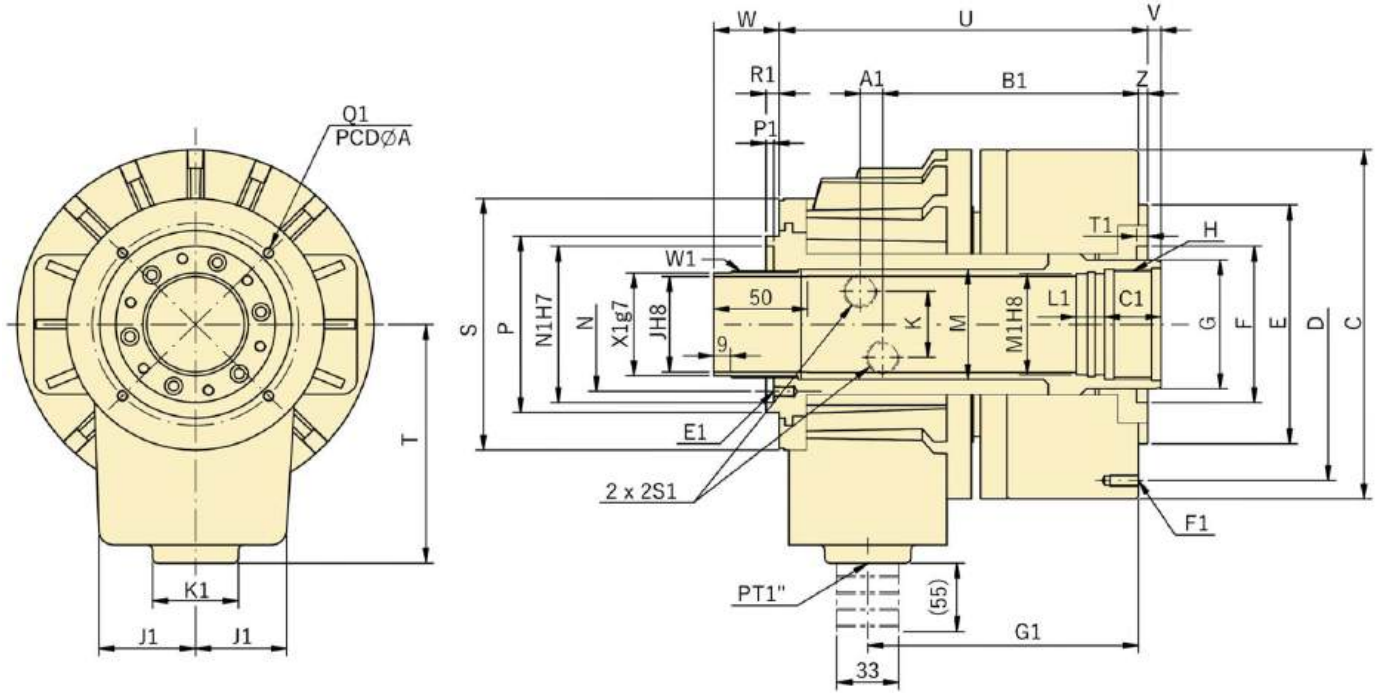

## DIMENSION

MODEL	C	D	E	F	G	H	J	K	M	N	P	S	T	U	V		W		Z	A
															Max.	Min.	Max.	Min.		
RC-4	115	100	80	65	44	M38x1.5	28	25	35	44	59	90	105	158	9	0	34	25	5	76
RC-5	135	115	100	65	48	M42x1.5	36	30	44.8	55	73	106	115	175.5	10	-5	40	25	5	88
RC-6S	155	130	100	80	65	M55x2	36	36	52.9	64	85	118	115	184	10	-5	40	25	5	98
RC-6	155	130	100	80	65	M55x2	46	36	52.9	64	85	118	115	184	10	-5	40	25	5	98
RC-8S	190	170	130	85	70	M55x2	46	36	59.4	73	96	137	130	196	17	-5	47	25	5	110
RC-8	190	170	130	85	70	M60x2	52	36	59.4	73	96	137	130	196	17	-5	47	25	5	110
RC-10S	215	190	160	120	95	M75x2	68	36	84.6	98	121	166	160	230	20	-5	50	25	5	155
RC-10	215	190	160	120	95	M85x2	75	36	84.6	98	121	166	160	230	20	-5	50	25	5	155
RC-10X	215	190	160	120	95	M87x2	78	36	84.6	98	121	166	160	230	20	-5	50	25	5	155
RC-12	240	215	180	140	110	M100x2	91	36	99.6	108	138	182	185	253	25	-5	50	25	5	165
RC-15	310	275	230	166	140	M130x2	117.5	36	118	148	178	225	215	267	18	-5	56	33	5	206
RC-2814	340	280	-	240	190	M158x3	145	30	178	190	218	285	250	279	41	-1	75	33	-	260
RC-2816	340	280	-	240	190	M180x3	166.5	30	178	190	218	285	250	279	41	-1	75	33	-	260

## DIMENSION

MODEL	A1	B1	C1	E1	F1	G1	J1	K1	L1	M1	N1	P1	Q1	R1	S1	T1	W1	X1
RC-4	9.5	106	25	M6x10	M8x20	114.5	60	47	15	30	53	4	M4x10	5	PT 3/8	6	M34x1.5	32
RC-5	11	120.5	25	M5x9	M10x20	126.5	66	47	15	38	64	4	M5x10	5	PT 3/8	6	M44x1.5	42
RC-6S	11.5	126.5	30	M6x9	M10x20	135	76	47	15	50	76	4	M5x10	6	PT 1/2	6	M52x1.5	50
RC-6	11.5	126.5	30	M6x9	M10x20	135	76	47	15	50	76	4	M5x10	6	PT 1/2	6	M52x1.5	50
RC-8S	12	136	30	M6x9	M10x20	145	86	47	15	50	85	4	M6x12	7	PT 1/2	6	M58x1.5	56
RC-8	12	136	30	M6x9	M10x20	145	86	47	15	55	85	4	M6x12	7	PT 1/2	6	M58x1.5	56
RC-10S	17.5	153.5	35	M6x9	M10x20	166.5	101	47	15	76	108	4	M6x12	7	PT 1/2	6	M84x2.0	81
RC-10	17.5	153.5	35	M6x9	M10x20	166.5	101	47	15	80	108	4	M6x12	7	PT 1/2	6	M84x2.0	81
RC-10X	17.5	153.5	35	M6x9	M10x20	166.5	101	47	15	82	108	4	M6x12	7	PT 1/2	6	M84x2.0	81
RC-12	21	168	35	M6x14	M12x24	183	110	47	15	95	120	4	M6x12	7	PT 1/2	6	M99x2.0	96
RC-15	21	153.5	45	M6x10.5	M16x24	197	129	55	20	123	160	5	M6x12	7	PT 1/2	6	M134x2.0	131
RC-2814	13.5	202	45	M6x10.5	M16x30	216	163	67	150	150	174.5	5	M6x12	7	PT 1/2	6	M177x2.0	174.5
RC-2816	13.5	202	45	M6x10.5	M16x30	216	163	67	150	170	174.5	5	M6x12	7	PT 1/2	6	M177x2.0	174.5